



UNIVERSITY of CALIFORNIA

Agriculture & Natural Resources

COOPERATIVE EXTENSION COLUSA COUNTY

P. O. Box 180, 100 Sunrise Blvd., Suite E, Colusa, CA 95932

Tel. (530) 458-0570 Fax (530) 458-4625



RICE



BRIEFS

August 23, 2007

IN THIS ISSUE. . .

- Announcing our new Rice Advisor
- Resistant Watergrass Control Field Meeting

New Rice Farm Advisor for Colusa, Glenn and Yolo Counties

Luis Espino has joined UCCE as Rice Farm Advisor for Colusa, Glenn and Yolo counties. He has a Ph. D. in Entomology from Texas A&M University, where he worked under Dr. M. O. Way since 2002. His research focused on the rice stink bug, one of the most important pests of rice in the southern United States. Specifically, Luis worked on development of visual sampling methods and sequential sampling plans, identification of susceptible stages of rice development to rice stink bug attack, management and control. He also was involved in research conducted on other rice pests, such as rice water weevil, chinch bugs, rice stem borers and armyworms, and participated in extension activities.

Before starting the Entomology graduate program, Luis worked for an agrochemical company in Peru as part of the Product Development Department doing efficacy field trials and demonstrations, seminars and field days with producers of various crops.

He began his education by obtaining a B.S in Agronomy from La Molina University (Lima, Peru) in 1996 and a M.Ag. in Agronomy from Texas A&M University in 1999.

Luis can be contacted at the Colusa UCCE office at 530-458-0578, at 530-635-6234 (cell phone) or at laespino@ucdavis.edu

University of California Resistant Watergrass Control Field Meeting

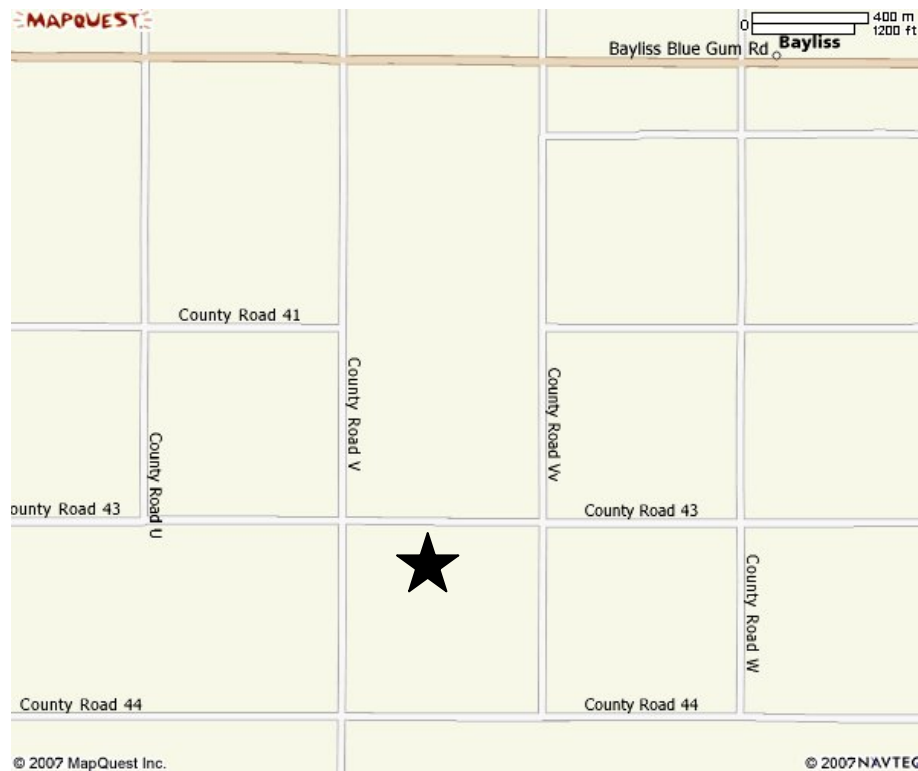

**Location: Thad Rodgers' Farm, Glenn County
¼ mile east of Road V on Road 43**
Date: Wednesday, September 5, 2007
Time: 9:00 am



View University of California rice herbicide trials.
Discussion of herbicide options currently available to growers for
control of resistant “mimic” watergrass and potential herbicide
options that may be available in the future.



Albert J. Fischer, Associate Professor, Weed Science program, Plant Sciences, U.C. Davis
James W. Eckert, Staff Research Associate, Plant Sciences, U.C. Davis
Luis Espino, UCCE Farm Advisor for Colusa, Glenn and Yolo Counties
Chris A. Greer, UCCE Farm Advisor for Sutter/Yuba, Placer & Sacramento Counties
Cass Mutters, UCCE Farm Advisor for Butte County



This meeting announcement is produced by:

Luis Espino

**Rice Farm Advisor
Colusa, Glenn & Yolo Counties**

P.O. Box 180
100 Sunrise Blvd., Suite E
Colusa, CA 95932
(530) 458-0570
(530) 635-6234
Email: laespino@ucdavis.edu

In cooperation with:

Chris Greer

**Rice Farm Advisor
Sutter/Yuba, Placer &
Sacramento Counties**

142A Garden Highway
Yuba City, CA 95991
(530) 822-7515
(530) 701-8674
Email: cagreer@ucdavis.edu



To simplify information, tradenames of products have been used. No endorsements of named products is intended, nor is criticism of similar products which are not mentioned.

The University of California prohibits discrimination or harassment of any person on the basis of race, color, national origin, religion, sex, gender identity, pregnancy (including childbirth, and medical conditions related to pregnancy or childbirth), physical or mental disability, medical condition (cancer-related or genetic characteristics), ancestry, marital status, age, sexual orientation, citizenship, or status as a covered veteran (covered veterans are special disabled veterans, recently separated veterans, Vietnam era veterans, or any other veterans who served on active duty during a war or in a campaign or expedition for which a campaign badge has been authorized) in any of its programs or activities. University policy is intended to be consistent with the provisions of applicable State and Federal laws. Inquiries regarding the University's nondiscrimination policies may be directed to the Affirmative Action/Staff Personnel Services Director, University of California, Agriculture and Natural Resources, 300 Lakeside Drive, 6th Floor, Oakland, CA 94612-3550, (510) 987-0096.

Co-operative Extension Work in Agriculture and Home Economics U.S. Department of Agriculture, University of California, and County of Colusa co-operating.

**COOPERATIVE EXTENSION
University of California
P.O. Box 180
Colusa, CA 95932**

**Non-Profit Org.
U.S. POSTAGE
P A I D
Colusa, CA
95932
Permit No. 3**

Rice Briefs